

Digital manometers type PTLD

Type : PTLD
PTLD - bat.
PTLD - kont.

Application :

For gaseous and liquid media that will not obstruct the pressure system.

Description :

Protection

IP 43, according to STN EN 60 529

Connection

Radial (lower)

Accuracy class

0,5 %

Visual display

8 – digit alphanumeric display

Power supply

PTLD 12-24V/DC
PTLD - bat. 2x1,5V – battery (AA)
PTLD - kont. 12-24V/DC

Output

PTLD 4-20mA
PTLD - bat. without output
PTLD - kont. 4 x relay

Allowed temperature

ambient : -20 ... +60°C
medium : -20 ... +120°C

Material

Measuring element: membrane 1.4571
Connection : stainless steel 1.4301
Case : stainless steel 1.4301
Visor : PVC
Sealing : FPM - Viton

Options

- accuracy class 0,25% or better on request
- other range on request
- measuring of absolute pressure
- front flange
- other connection (thread) on special request
- option mounting with diaphragm separator
- output 0-20mA, 0-10V



Allowed loading

Static : 75% from range
Variable : 66% from range
For a short term : 100% from range

Dimensions of manometer (mm)

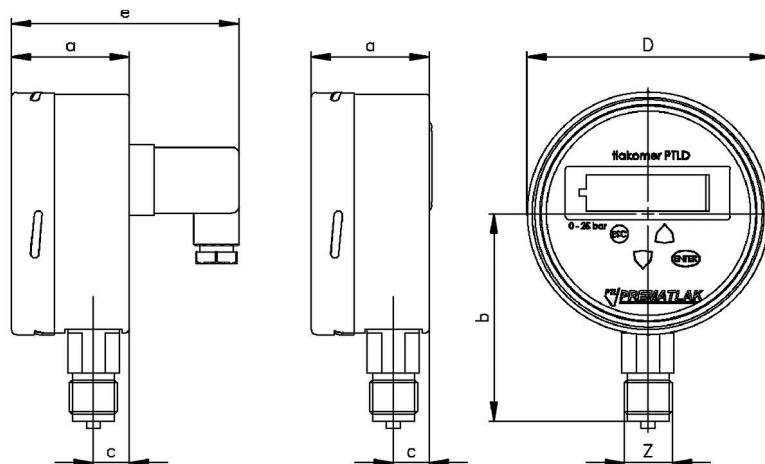

TYPE	D	A	b	c	e	Z
PTLD	101	49	86	16	96	M20x1,5 (G1/2")
PTLD-bat.	101	49	86	16	96	M20x1,5 (G1/2")
PTLD-kont.	101	49	86	16	96	M20x1,5 (G1/2")

Digital manometers type PTLD

Type :

PTLD
PTLD - bat.
PTLD - kont.

Producing ranges



Range	PTLD	PTLD - bat.	PTLD - cont.
0-6kPa	X	X	X
0-10kPa	X	X	X
0-16kPa	X	X	X
0-25kPa	X	X	X
0-40kPa	X	X	X
0-60kPa	X	X	X
0-100kPa	X	X	X
0-160kPa	X	X	X
0-250kPa	X	X	X
0-400kPa	X	X	X
0-600kPa	X	X	X
0-1MPa	X	X	X
0-1,6MPa	X	X	X
0-2,5MPa	X	X	X
0-4MPa	X	X	X
0-6MPa	X	X	X
0-10MPa	X	X	X
0-16MPa	X	X	X
0-25MPa	X	X	X
0-40MPa	X	X	X
0-60MPa	X	X	X
0-100MPa	X	X	X
-100-0kPa	X	X	X
-100-0-60kPa	X	X	X
-100-0-150kPa	X	X	X
-100-0-300kPa	X	X	X
-100-0-500kPa	X	X	X
-100-0-900kPa	X	X	X
-0,1-0-1,5MPa	X	X	X
-0,1-0-2,4MPa	X	X	X